



MARLOWTOWNCOUNCIL

The following planning applications will be considered at the meeting of the Planning & Transportation Committee to be held on **17th July 2024** at 7.00 pm.

Planning Sheet Ref: **17.07.24**

Applications Received: **20.06.24** to **11.07.24**

xx x License Applications

1 x Tree Applications

13 x Full Planning Applications

4 x Tree Works Applications

[Parking Standards and Guidance](#)

Address	Oxford Cottage Oxford Road
Reference	24/06549/TREE
Applicant	Catsaras
Description	Crown reduce by 3 metres. to 2 x Beech trees (G1) to reduce the risk of failure from future high winds, mixed with the deteriorating root system will provide a safety management plan and fell 5 x Ash trees (G2) as trees are causing concern given their location and high risk of potential failure
MTC Decision	No objection subject to tree officer approval



Address	17 Holland Road
Reference	24/06371/FUL
Applicant	Mr Joel Bekaert
Description	Householder application for construction of part two storey, part single storey side and rear extension, single storey front extension and permeable hardstanding to extend front drive
MTC Decision	No objection

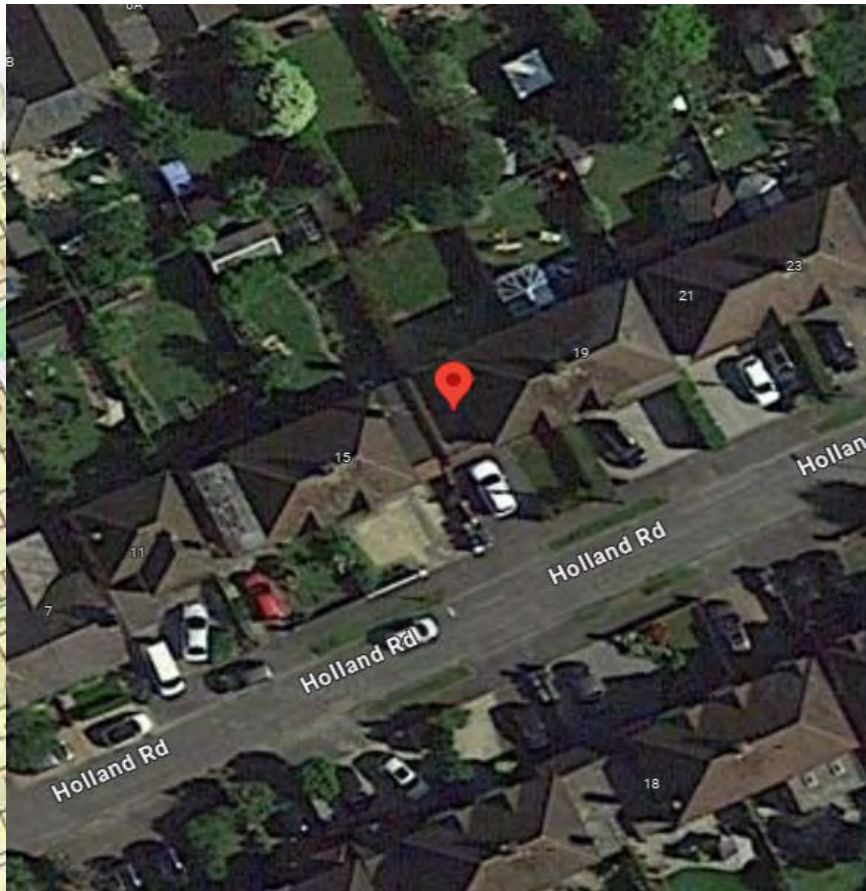

Address	Land Adjacent 10 Copse Close
Reference	24/06418/FUL
Applicant	Mr Hobbs
Description	Erection of 1 x 2 bed detached house
MTC Decision	No objection subject to highways commenting on the exit to Barnards Hill

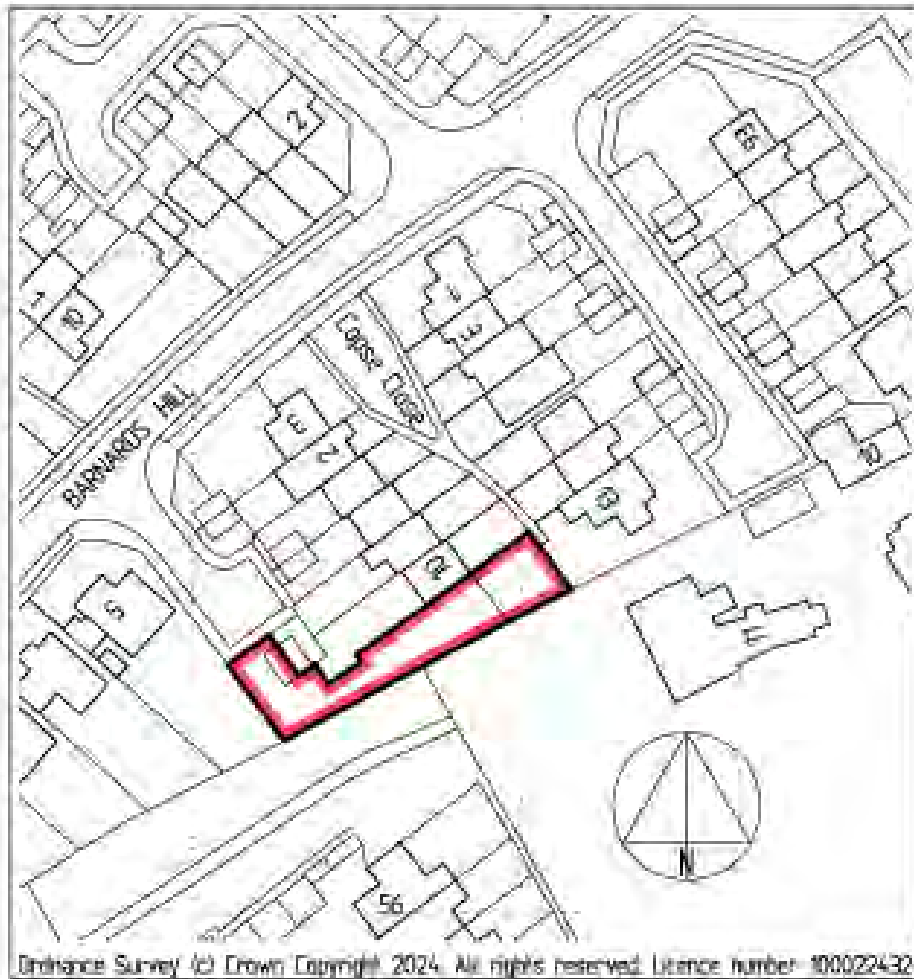

Address	70 Crown Road
Reference	24/05946/FUL
Applicant	Mrs Slator
Description	Householder application for construction of ground floor side extension following demolition of existing lean-to
MTC Decision	No objection

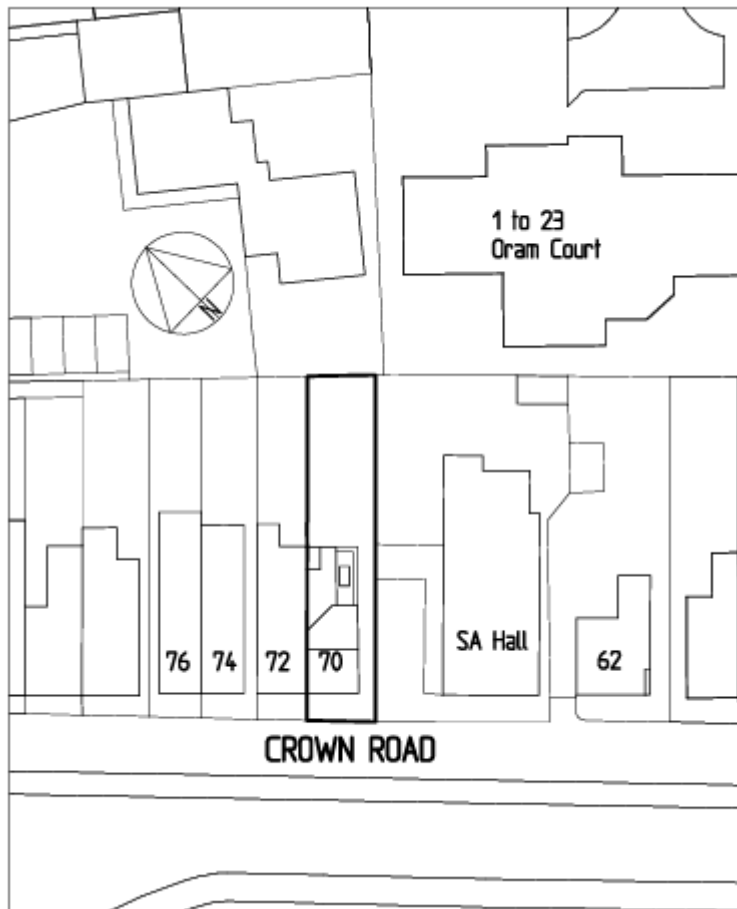

Address	4 Harcourt Gardens
Reference	24/05891/FUL
Applicant	Janis Prescott
Description	Construction of new flat roof dormer to rear roof pitch, velux windows to front and side pitches in connection with loft conversion to habitable living space
MTC Decision	No objection



Address	102 High Street
Reference	24/06441/LBC
Applicant	Mr Tom Tipper
Description	Listed building application for replacement of 2 No. windows to the southwest rear of the property
MTC Decision	No objection subject to conservation officer approval

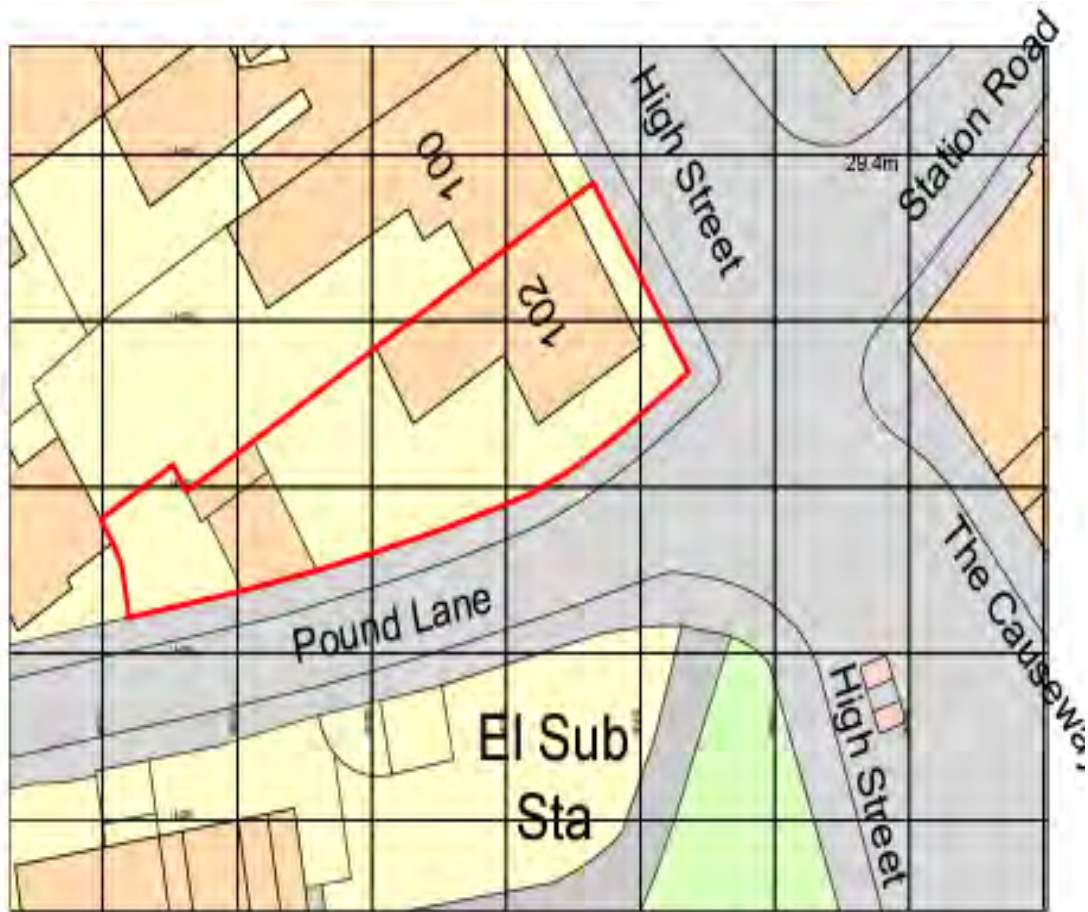

Address	62 Station Road
Reference	24/06365/FUL
Applicant	Mr Jake Flannery
Description	Householder application for removal of hedge to be replaced with black metal railings and dropped kerb to allow vehicular access (part retrospective)
MTC Decision	No objection subject to highways approval



Address	25 Claremont Road
Reference	24/06440/FUL
Applicant	Mr M Bell
Description	Householder application for construction of single storey rear/side extension and new velux roof lights to the main roof
MTC Decision	No objection



Address	21 Gossmore Lane
Reference	24/06478/VCDN
Applicant	Mr & Mrs Ellis
Description	Variation of conditions 2 (Plans) and 3 (Materials) attached to 23/06264/FUL (Householder application for demolition of the existing conservatory, the erection of a new porch and bay window, the erection of a ground floor rear extension, a replacement roof with two front dormer windows and 3 x velux roof lights, rendering to all elevations and alterations to the existing fenestration with increase of ridge height) to allow for substitution of drawings
MTC Decision	No objection

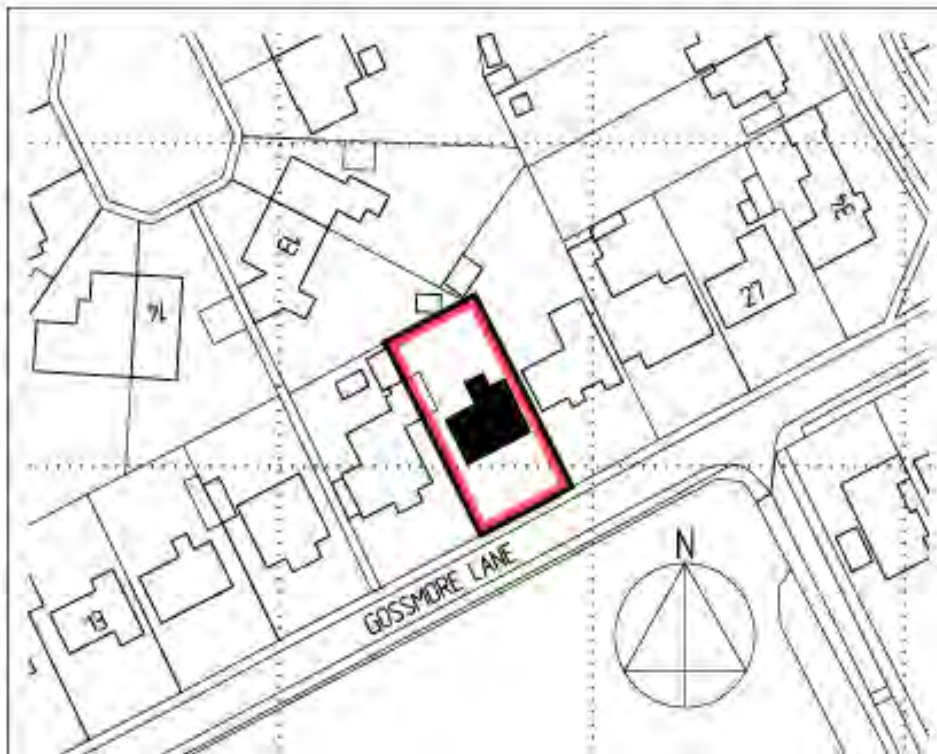

Address	48 Stapleton Close
Reference	24/06382/FUL
Applicant	Mr Ian Elgey
Description	Householder application for construction of first floor rear extension and lean-to roof infill of rear single storey projection
MTC Decision	No objection

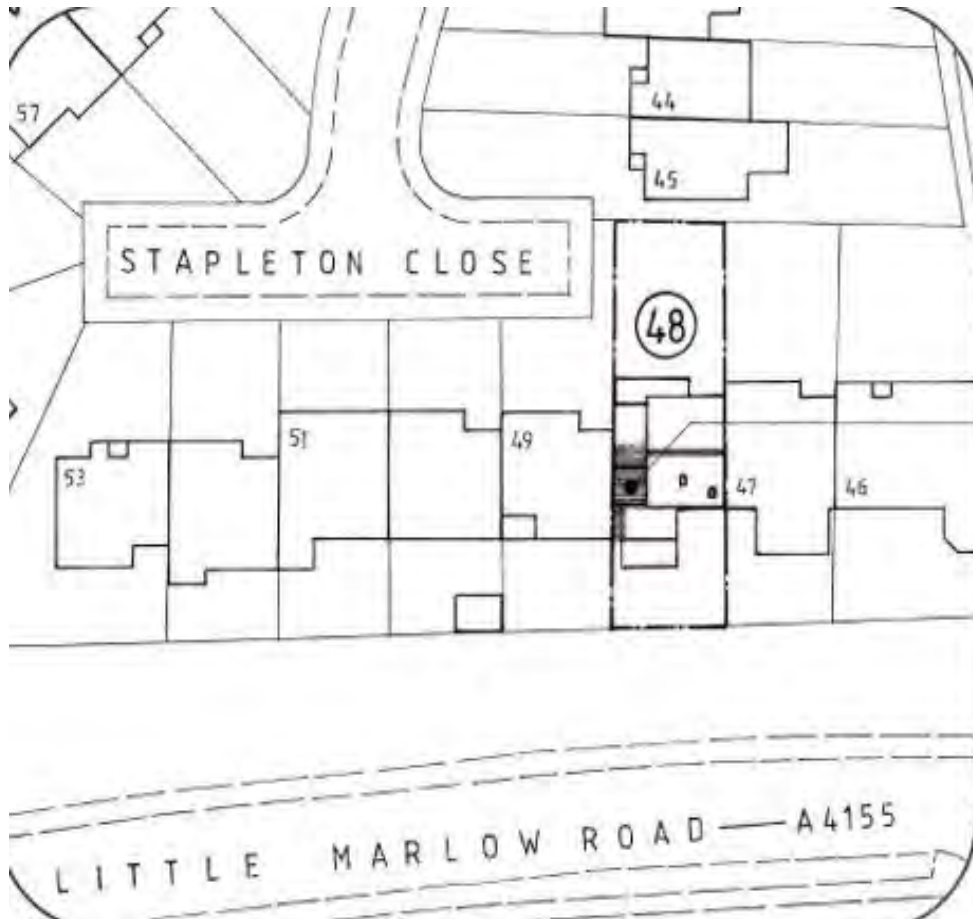

Address	22 High Street
Reference	24/06498/FUL
Applicant	Sorbon Estates
Description	Construction of two storey rear extension to form ground and first floor flats with amenity space, cycle and bin storage
MTC Decision	No objection



Address	Stoneycroft Spinfield Lane
Reference	24/06527/FUL
Applicant	James Hick
Description	Householder application for construction of part two storey, part single storey front extension, facade alterations, introduction of side dormer, solar panels and all associated works
MTC Decision	No objection



Address	4 Beaufort Gardens
Reference	24/06521/FUL
Applicant	Mr M Cornwell
Description	Householder application for insertion of roof lights, log burner flue and replacement porch
MTC Decision	No objection

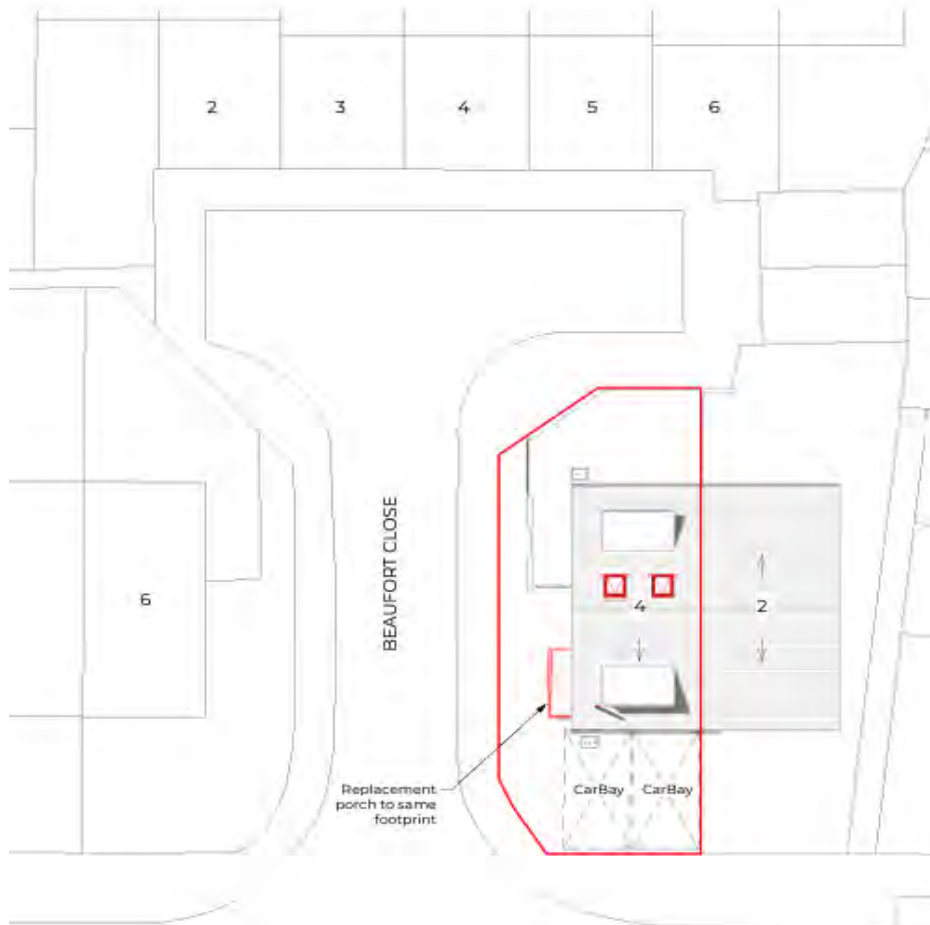

Address	8 Beverley Close
Reference	24/06547/FUL
Applicant	Miss Tammy Davis
Description	Householder application for replacement of existing flat roof to front and side with new pitched roof, replacement windows and doors to ground floor rear, and replacement of front tiles and cladding
MTC Decision	No objection



Address	55 Glade Road
Reference	24/06417/TPO
Applicant	MR BENJAMIN DOWNING
Description	Crown reduce by approx 0.8 - 1.0 metres to suitable growth points, to reduce the effects of shading, light loss and to maintain clearance from the property x 1 Magnolia (T1)
MTC Decision	No objection subject to tree officer approval

Address	High Spinfield, Spinfield Lane West
Reference	24/06403/TPO
Applicant	Mr Adrian Nicholls
Description	Raise the height to 5.2m to clear over the road to make it safe for vehicles, to clear the barn roof and phone line x 4 Yew
MTC Decision	No objection subject to tree officer approval

Address	4 The Acre
Reference	24/06448/TPO
Applicant	Tony Rickard
Description	4 meter crown reduction and crown lift to 6 meters to 1 x Ash tree (T1) to provide sufficient clearance to property
MTC Decision	No objection subject to tree officer approval

Address	36 Pound Lane
Reference	24/06559/TPO
Applicant	Richardson
Description	Reduce crown to previous reduction points approximately 4 m of height and 6 m of lateral growth to 1 x Robinia (T1) and remove split limb and deadwood to maintain size of tree
MTC Decision	No objection subject to tree officer approval